



orange

nest

Cosy living. Fresh life.



Life is a bridge
between two breathes



Breathing in fresh air
is living



Living fresh

is life



Life ~ just four letters that spell
million moments of joy.

The joy of breathing in fresh air,
a gentle breeze that fills your bosom
with a crisp aroma of the mother nature,
the exhilaration of an early morning walk
on a path of soothing grass caressing your feet,
that is just the beginning...

Life is full of pleasant surprises.

There is no celebration bigger than life itself.
Experience a true celebration called 'life'.





Come to Orange Nest

Cosy living. Fresh life.

A place to nestle in nature's bosom. You find your reflection in the sprawling waterbody before you. You breathe air through the foliage on your window sill. You stand amid a verdant garden on your roof. Your child may play there in the open. Or you just relax on the sleek seats with your partner. Otherwise, you spend your leisure in the stylish interior of your spacious home. You need not worry about your personal car as you have parked it just beneath your home, secured. In fact, every aspect of your niche is secured with round-the-clock maintenance. You remain well connected with your posh neighborhood and the outside world in this prime spot of the city. And virtual connection is just a matter of click; your abode is snuggled inside a wifi zone.

Freshness of Life

Rediscover nature in the landscaped gardens amidst lush green surroundings in more than 50% open area. Open up yourself amongst thousands of plants and trees. Inhale the fragrance of flowers. Listen to the chirping of birds. Allow mother nature to rejuvenate you. Feel the cosiness of life.









Fitness for Life

A brisk walk along the paved path in the garden refreshes you at dawn. Gardens are everywhere, beneath your home and over it. You may have your fitness jogging at the ground garden or its twin on the roof-top.

Besides, an elusive work-out in the equipped gym keeps you fit & fresh.

Kids may cool down in the natural waterbody that comes attached with your home.

The reading room and the hobby centre are there for the celebration of your leisure.

Peace for Life

Just when you feel like taking things a bit easy, you find a temple and a meditation hall within your complex.

To discover the inner peace, you may start your day with a prayer there. Or you may just meditate for complete peace of mind. That gives you the power & the positive energy for a day. The ambient light and the cool breeze around the campus make your evenings pleasurable.







Amenities for Life

- Open Area
- Gymnasium
- Free WiFi
- Car Parking
- 24 Hour Power
- Natural Waterbody
- Community Hall
- Terrace Garden
- 24 Hour Security
- Back-up

Specifications

Structure: Earthquake resistant with RCC framed structure resting on individual columns.

External Wall: 8 inch brick wall, plastered with cement mortar, antifungal weather coat.

Internal Wall: 3 inch thick brick wall, plastered with cement mortar.

Flooring: Entire flat will be finished with vitrified tiles.

Toilets: Wall to have ceramic tiles upto door height.

Water Closets: European type commode, standard wash basin, rain shower, water line with provision for installation of geyser. Sleek CP fittings. All the pipe line will be concealed.

Kitchen: Black stone cooking platform with one stainless steel sink, drain board & ceramic tiles upto a height of two & half feet above the cooking level.

Doors: All door frames with flush shutters which have commercial faced, inner sides painted with matching enamel paint. Entrance door will have latch. Bedroom & Kitchen doors will have mortise lock & door stopper. Toilet door will have bathroom latch.

Windows: All windows will be standard powder coated casement aluminium window with glass inserted in shutter fitted with standard handles.

Electrical:

Total concealed wiring for all the rooms provided with electrolytic copper conductors.

A.C. plug points in master bedroom.

Geyser point in all bathrooms.

Light & Plug points in living/ dining & bedrooms as per architectural drawings.

Electric Calling bell at the main door.

TV point in living room.





Location of Life



Connectivity:

Next to Rajarhat New Town Eco Tourism Park

Near International Financial Hub

2 min to Metro Stn. on the proposed Airport–New Garia Metro line

5 min to New Town Bus Terminus

5 min walking distance from Major Arterial Road (South East)

5 min to Hospital, College, University

7 min to Sector V

GROUND FLOOR PLAN



TYPICAL FLOOR PLAN

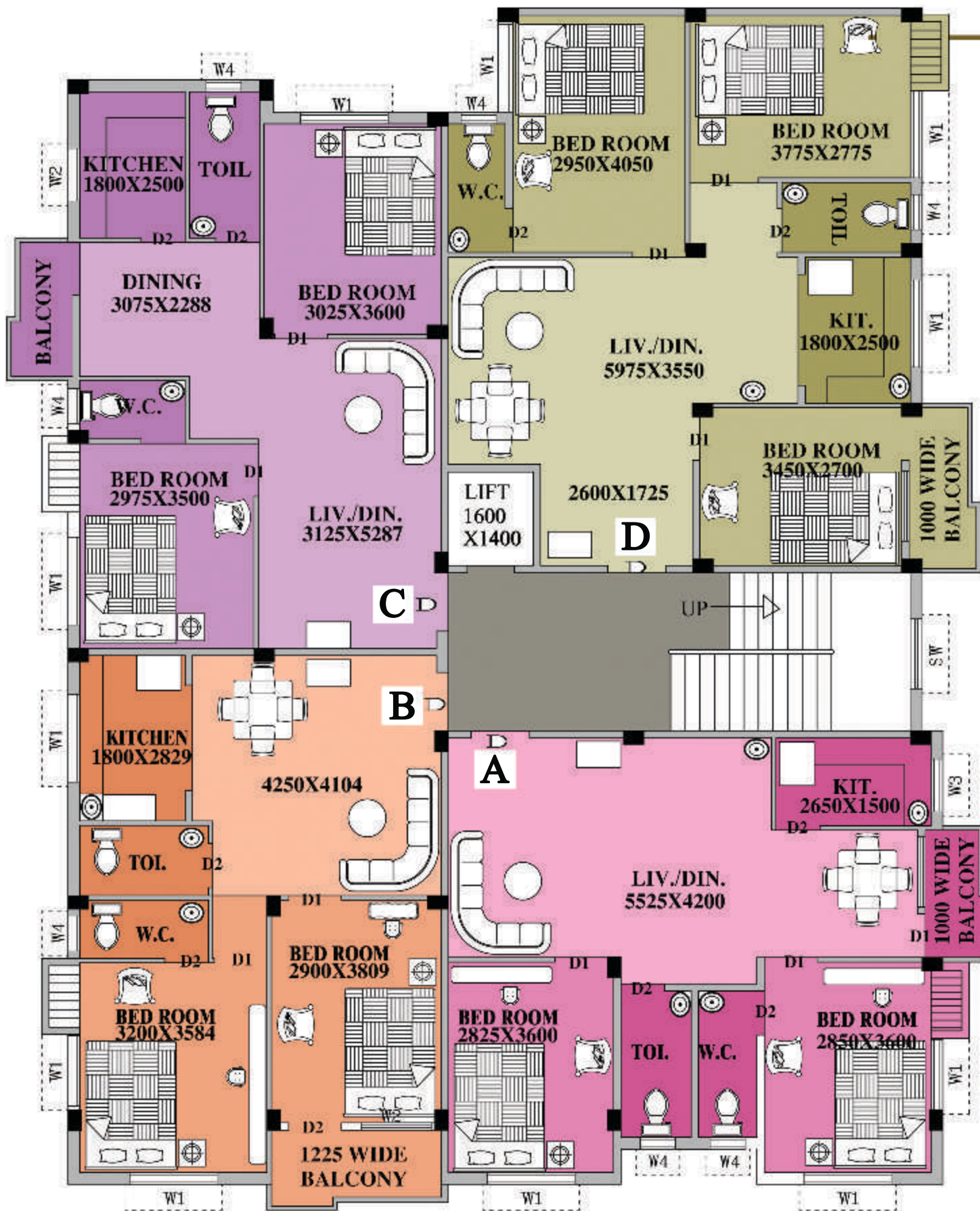

- 2BHK –
- A – 951 SQFT
- B – 881 SQFT
- C – 940 SQFT
- 3BHK –
- D – 1135 SQFT

TYPICAL FLOOR PLAN

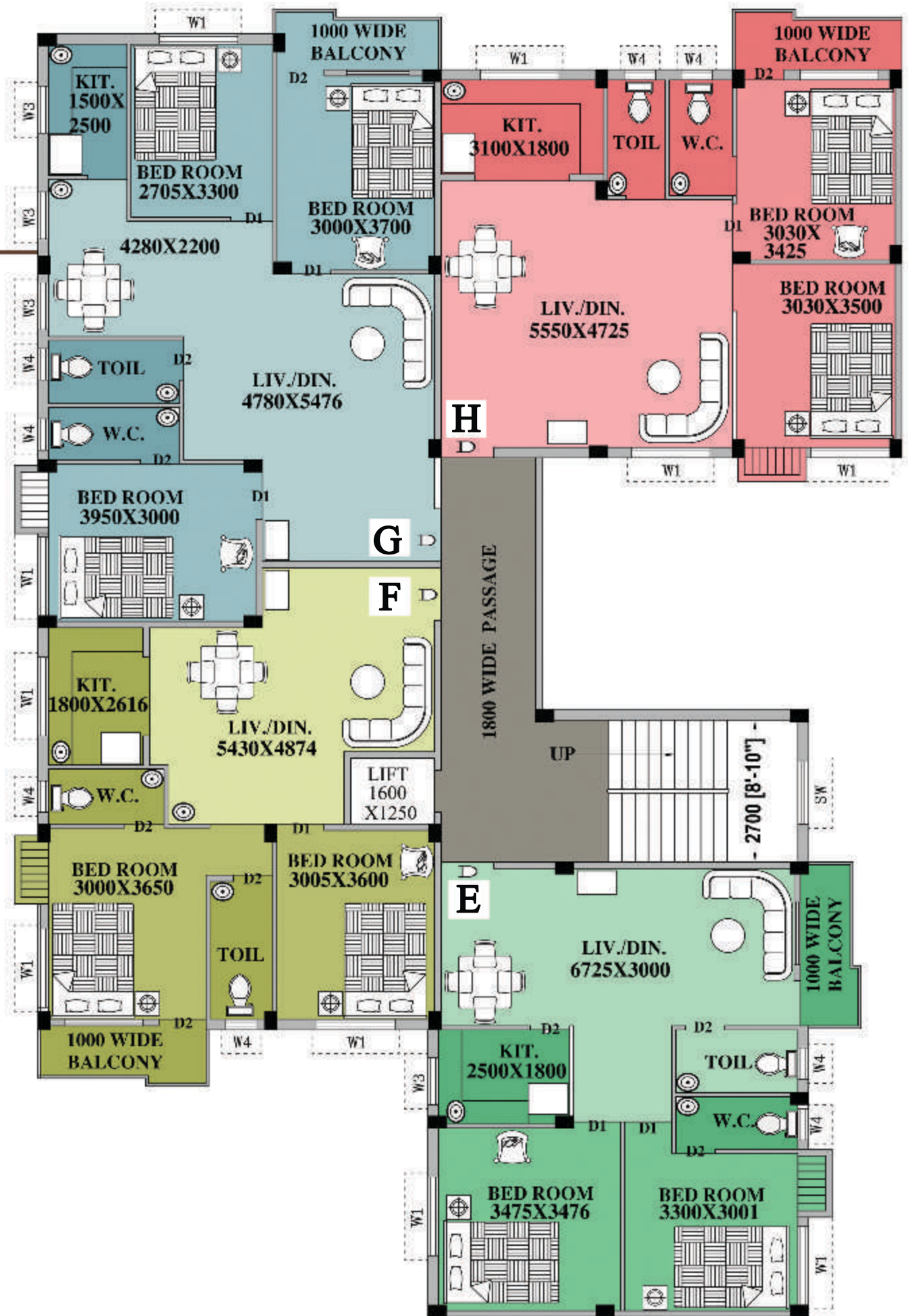

2BHK –

E – 984 SQFT

F – 968 SQFT

H – 1040 SQFT

3BHK –

G – 1262 SQFT

TYPICAL FLOOR PLAN



- 2BHK –
- I – 1042 SQFT
 - J – 1214 SQFT
 - K – 1034 SQFT
- 3BHK –
- L – 1301 SQFT
 - M – 1226 SQFT

For further information please contact:

Cancun Bhumi Pvt. Ltd.
Santosh Enclave, 3rd Floor
14,Chinar Park, Kolkata – 157

T: +91 033 2570 0094
www.cancunbhumi.com

Developer:



Powered by: Vinodini

Disclaimer–All specifications, drawings, amenities, facilities, etc. shown in this brochure are subject to change as per the approval from the respective authorities. The final discretion remains with the developers.